

Remarks:Route

- 1) Kanjanaphisek Rd, or Highway no.9 (Outer Bangkok Ring) to Bang-Pain, take Lamlukka exit, keep left, follow signs for Phahon Yothin approx. 300 meter (closed Yong Soong LP)
- 2) Vibhadi-Rangsit Rd, via National Memorial (your right), keep left, follow signs for Lamlukka and turn left to Lamlukka Rd. through Thanvathani Golf Course, go straight to U-Turn at BIG-C Klong5 approx. 2 km. (closed Yong Soong LP)
- 3) Phahon Yothin Rd, via National Memorial, keep right to U-term (under the bridge) and turn left to Lamlukka Rd. through Thanvathani Golf Course, go straight to U-Turn at BIG-C Klong5 approx. 2 km. (closed Yong Soong LP)
- 4) By Bus transportation: No. 543- Bangkhen-Sapanmai-Lamlukka (Klong 9) and No. 6250 Rangsit-Lamlukka Klong 9

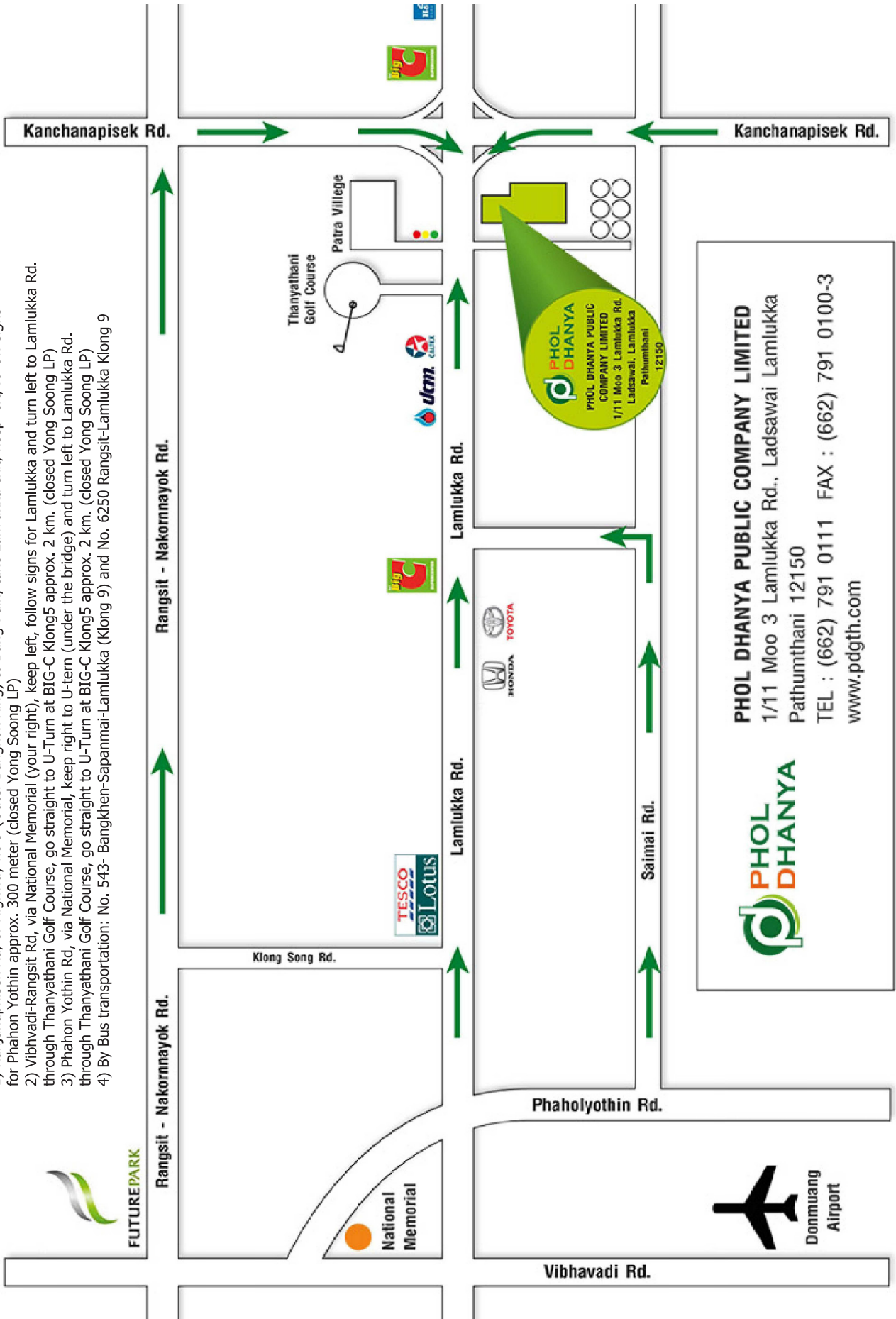

PHOL DHANYA PUBLIC COMPANY LIMITED
 1/11 Moo 3 Lamlukka Rd., Ladsawai Lamlukka
 Pathumthani 12150
 TEL : (662) 791 0111 FAX : (662) 791 0100-3
 www.pdgth.com